

Instruction for mounting and dismounting of the sensor tube of type: PA01-SNS 4x6

All rights strictly reserved except when stipulated otherwise expressly by contract. Reproduction or issue to third parties in any form whatsoever is not permitted without written authority from the proprietors.

1. Mounting

1.1 Tools for mounting



Tube shear, Type: PA01-SCS, P/N: 90 126



Tube deburring tool, Type: PA01-SEG, P/N: 90 125

1.2 Basic information for the installation of the sensor tube

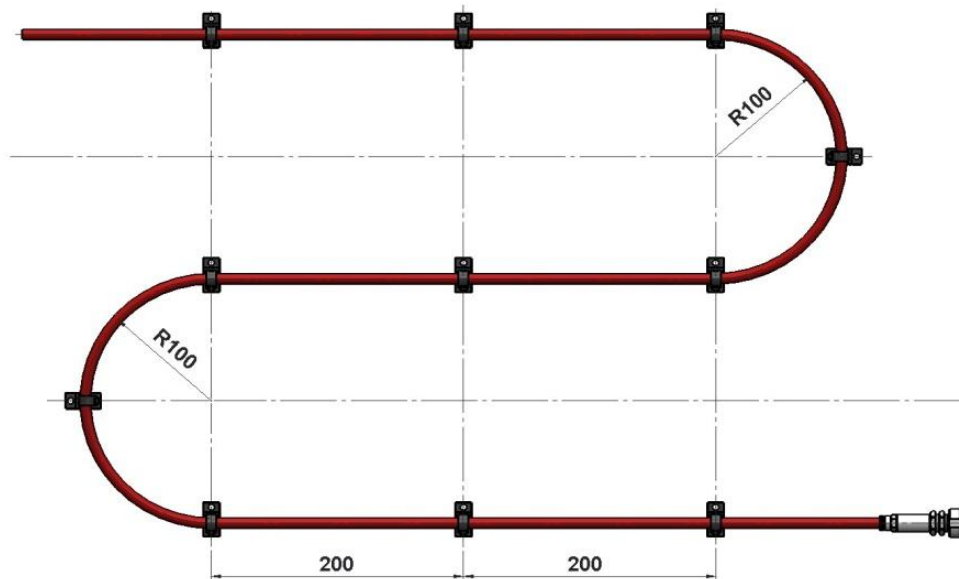

- To ensure a sufficient flexibility the sensor tube has to be installed at ambient temperatures above +10°C.
- minimal bending radius: 100 mm for sensor tube 4 x 6
- The sensor tube must not be squeezed, buckled or damaged by sharp edges. Damages at the sensor tubes are often visible when there is a bright discoloring at a kink (stress whitening). This does not mean an immediate leakage of the tube but these damaged areas may burst without fire exposure. Therefore the complete damaged tube has to be replaced.
- The sensor tube has solely to be connected by tested tube connectors.
- The tube mountings to fix the sensor tube for example to a wall should have a maximum distance of 200mm to one another. Additionally there should be a tube mounting at the highest point of a radius. Fixed in this way there will be only a minimum of deflection and movement caused by the blow back in case of a bursting tube. Screw mountings are always required.

Alle Rechte, soweit nicht vertraglich anders vereinbart, sind ausdrücklich vorbehalten. Vervielfältigung oder Mitteilung an Dritte, gleichgültig in welcher Form, ist ohne schriftliche Genehmigung des Eigentümers nicht gestattet.

Date 10/27/2016

Version 1/W.HR

EGON HARIG GmbH
Gewerbering 4 • D-22113 Oststeinbek
Tel./Phone: +49 (0)40 713752-0
Telefax: +49 (0)40 713752-24
E-Mail: egonharig@egonharig.de
www.egonharig.de www.flamtron.de

Instruction No

4.13264.8

Page 1 of 3

Instruction for mounting and dismounting of the sensor tube of type: PA01-SNS 4x6

All rights strictly reserved except when stipulated otherwise expressly by contract. Reproduction or issue to third parties in any form whatsoever is not permitted without written authority from the proprietors.

Alle Rechte, soweit nicht vertraglich anders vereinbart, sind ausdrücklich vorbehalten. Vervielfältigung oder Mitteilung an Dritte, gleichgültig in welcher Form, ist ohne schriftliche Genehmigung des Eigentümers nicht gestattet.

1.3 Processing of the tube ends before insertion into plug-in connectors

To connect sensor tubes to valves, releases or other accessories, different plug-in connectors are used.

To avoid leakages und damages at the plug-in connectors the following has to be observed:

- The tube ends have to be cut square and there should be no debris or swarf left. For this, use the tube shear.

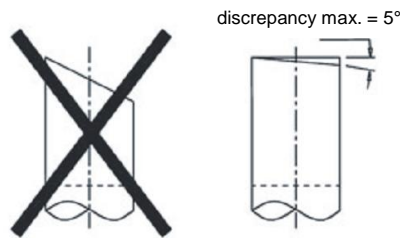

- Deburr the tube ends with the tube deburring tool to avoid damaging the o-rings in the plug-in connectors.

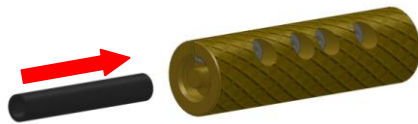

Insert the sensor tube into the tube deburring tool

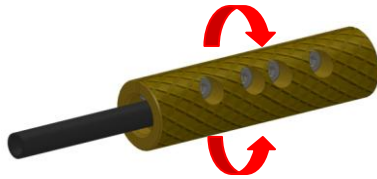

While carefully inserting the tube rotate the deburring tool until reaching the stop position.



The result is a chamfer of 20° which avoid damages of the plug-in connector's o-rings.

1.4 Insertion of the sensor tube into plug-in connectors

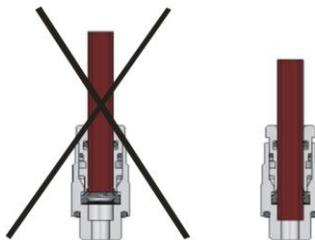

- Just take the tube in one hand and insert it into the plug-in connection, by passing both inner o-rings until feeling a well defined stop.
- To check the correct assembly of the sensor tube just pull the tube with little force.

Date 10/27/2016

Version 1/W.HR

EGON HARIG GmbH
Gewerbering 4 • D-22113 Oststeinbek
Tel./Phone: +49 (0)40 713752-0
Telefax: +49 (0)40 713752-24
E-Mail: egonharig@egonharig.de
www.egonharig.de www.flamtron.de

Instruction No

4.13264.8

Page 2 of 3

Instruction for mounting and dismounting of the sensor tube of type: PA01-SNS 4x6

All rights strictly reserved except when stipulated otherwise expressly by contract. Reproduction or issue to third parties in any form whatever is not permitted without written authority from the proprietors.

2. Dismounting

WARNING: High pressure!

Only skilled and competent personal may install, uninstall or maintain pneumatically systems. Secure the system against an unintentional actuation, then shut down the system and disassemble the sensor tube!

2.1 Tool for dismounting



Multi tool, Type: PA01-MWZ, P/N: 90 124

2.2 Dismounting of the sensor tube from the plug-in connectors

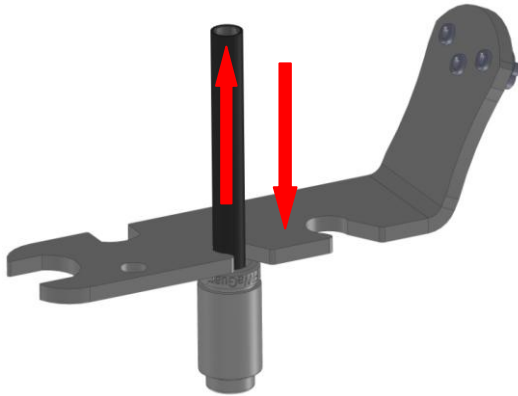

- Just press with one hand the disassembling multi tool and the spring chuck. By simultaneously pulling with the other hand the tube can easily be removed.

Alle Rechte, soweit nicht vertraglich anders vereinbart, sind ausdrücklich vorbehalten. Vervielfältigung oder Mitteilung an Dritte, gleichgültig in welcher Form, ist ohne schriftliche Genehmigung des Eigentümers nicht gestattet.

Date

10/27/2016

Version

1/W.HR

EGON HARIG GmbH
Gewerbering 4 • D-22113 Oststeinbek
Tel./Phone: +49 (0)40 713752-0
Telefax: +49 (0)40 713752-24
E-Mail: egonharig@egonharig.de
www.egonharig.de www.flamtron.de

Instruction No

4.13264.8

Page 3 of 3